

RoHS2.0
Compliant

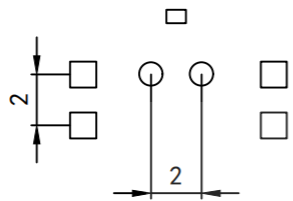

P. C. B LAYOUT

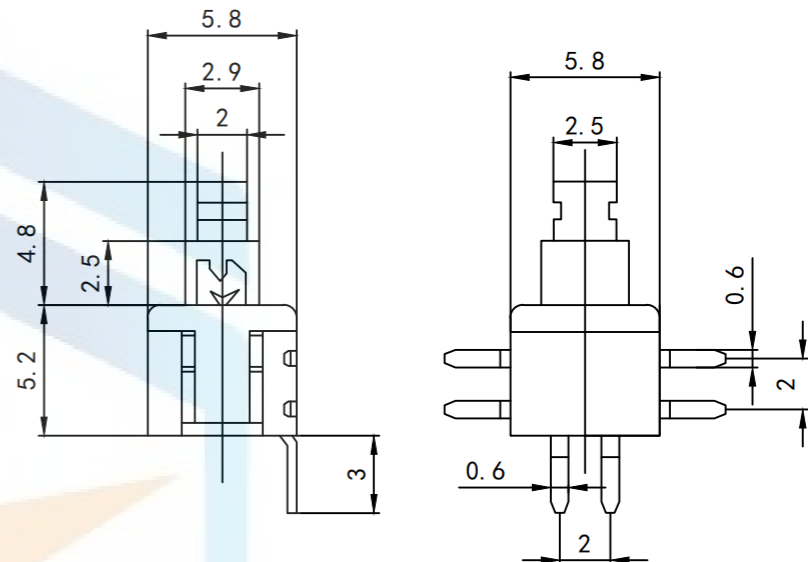
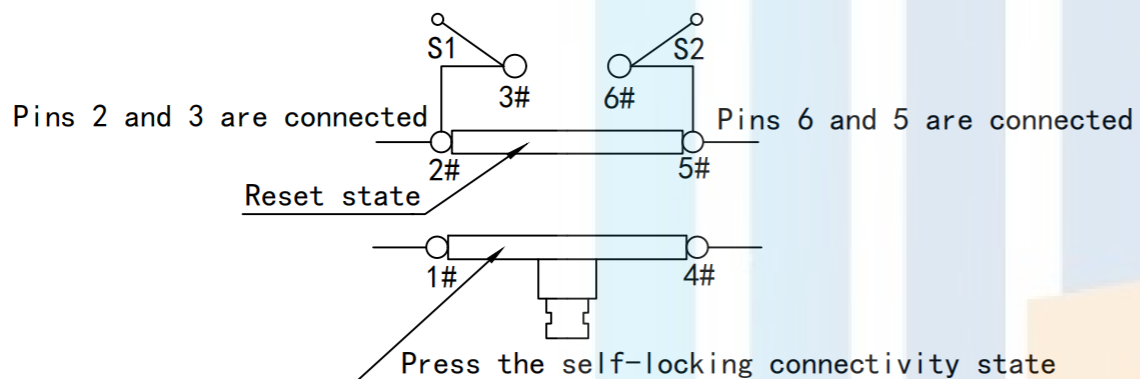

Specification of Self-Lock Switch:

Temperature: $-40\sim 70^{\circ}\text{C}$

Rated Load: DC 30V 0.1A

Contact Resistance: $\leq 30\text{m}\Omega$

Insulation Resistance: $\geq 100\text{M}$

Withstand Voltage: AC250V (50Hz) /min

Operation Force: $180\text{g} \pm 300\text{g}$

Life: 10000

TOLERANCE

X. XXX	± 0.05
X. XX	± 0.15
X. X	± 0.20
X.	± 0.30
ANGLE	$\pm 5.0^{\circ}$

PROTECTON

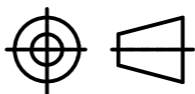

东莞市恒祺电子科技有限公司

Dongguan Hengqi Electronic Technology Co., Ltd

<https://www.hq-dz.com>

phone: 15812872448

TITLE:

按键开关
自(无)锁

PART NO: 5.8*5.8高头6脚卧贴

DRAWING NO: 5.8*5.8*10

DRAWN:

CHECKED:

APPROVED:

DATE:

DATE:

DATE:

18-10-08

18-10-08

18-10-08

UNIT:
mm

SCALE:
FULL

SIZE:
A4