

RoHS2.0  
Compliant

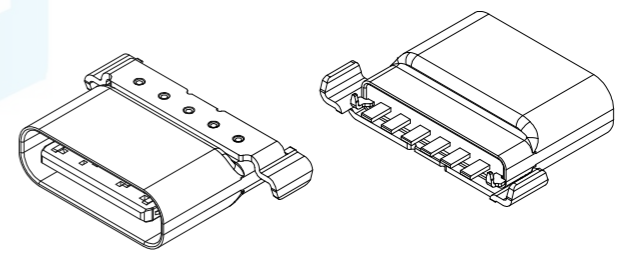
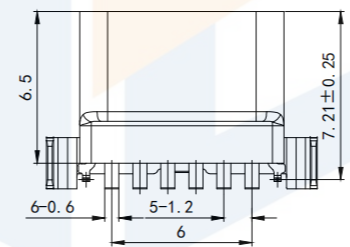
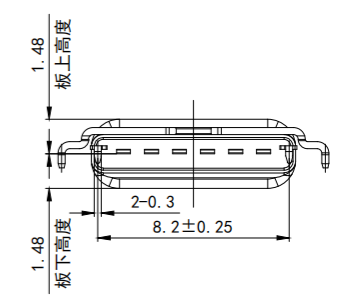
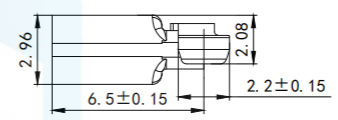
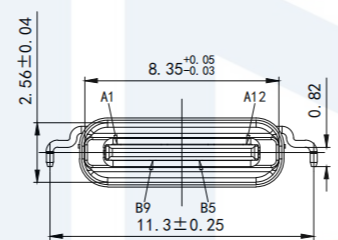
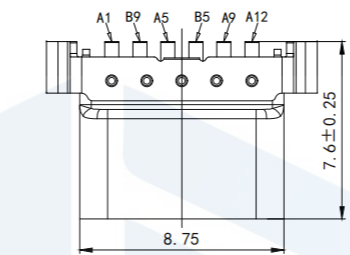
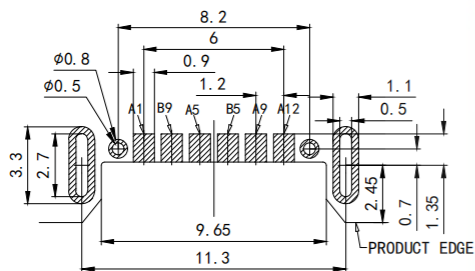

RECOMMEND P. C. B LAYOUT (COMPONENT SIDE)  
TOLERANCE FOR PCB LAYOUT IS  $\pm 0.05$

NOTE:

1. Electrical characteristics:
  - 1.1. Contact area: contact resistance 40m $\Omega$  Max, allowing 10m $\Omega$  variation  
Test conditions :20mv, 100mA measurement.
  - 1.2. Contact current: 3A VBUS pin; 1.25A for GND Pin; The other pins are 0.25A.
  - 1.3. Rated voltage: 5V.
  - 1.4. Withstand voltage: 100VAC.
  - 1.5. Insulation resistance: at least 100 megohm.
2. Mechanical properties:
  - 3.1. Insertion force: 0.5-2.0Kg
  - 3.2. Pullout force: 0.6-2.04Kg
  - 3.3. Insertion and removal times: 10000 times.
4. Weldability: temperature 210-230°C, time 10 seconds.
5. Working environment: -20°C to +85°C.

|                  |                 |   |  |                       |                                   |
|------------------|-----------------|---|--|-----------------------|-----------------------------------|
| <b>TOLERANCE</b> |                 |   | <b>东莞市恒祺电子科技有限公司</b><br>Dongguan Hengqi Electronic Technology Co., Ltd |                       |                                   |
| X. XXX           | $\pm 0.05$      |   | <a href="https://www.hq-dz.com">https://www.hq-dz.com</a>              |                       | phone:15812872448                 |
| X. XX            | $\pm 0.15$      | <b>TITLE:</b><br>TYPE C 6P 母座防水拉伸壳两脚护套<br>L=7.6 |  |                       | <b>PART NO:</b> TYPE-C6P-CB1076FS |
| X. X             | $\pm 0.20$      |   |  |                       | <b>DRAWING NO:</b> 11.3*2.96*6.5  |
| X.               | $\pm 0.30$      | <b>PROTECTON</b>                                |  | <b>DRAWN:</b>         | <b>DATE:</b> 18-10-08             |
| ANGLE            | $\pm 5.0^\circ$ |   |  | <b>CHECKED:</b>       | <b>DATE:</b> 18-10-08             |
|                  |                 | <b>APPROVED:</b>                                |  | <b>DATE:</b> 18-10-08 | <b>UNIT:</b> mm                   |
|                  |                 |   |  | <b>SCALE:</b> FULL    | <b>SIZE:</b> A4                   |