

RoHS2.0
Compliant

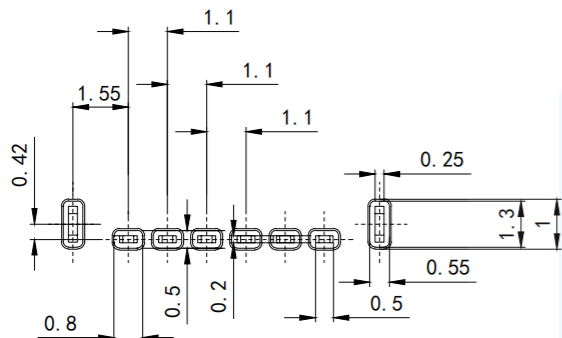

RECOMMEND P.C.B LAYOUT (COMPONENT SIDE)
TOLERANCE FOR PCB LAYOUT IS ± 0.05

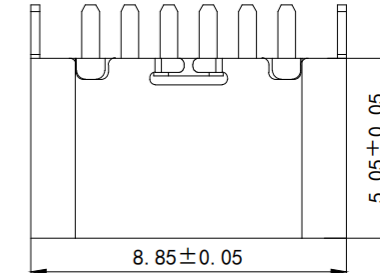
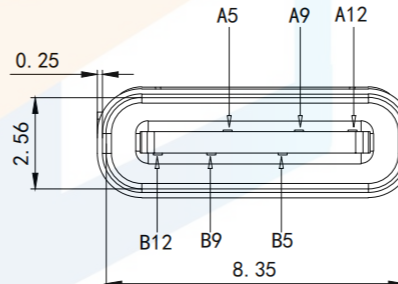
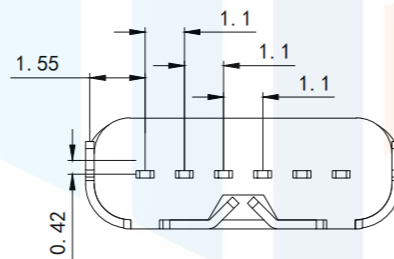
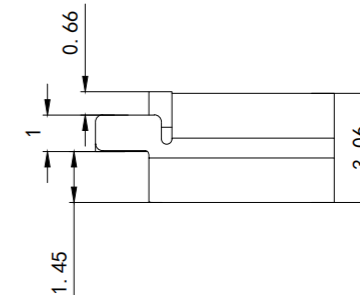
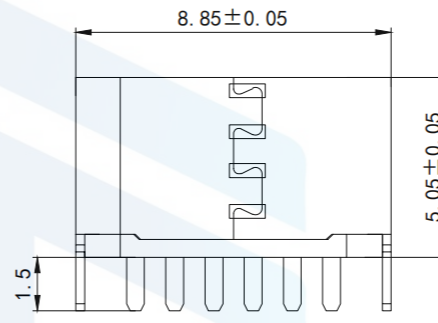
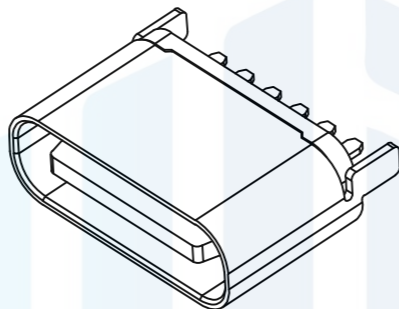

NOTE:

- 1 Material:
 - 1.1 Rubber core :LCP UL94 V-0
 - 1.2 Terminal :C2680,T=0.2mm; Nickel base, gold plated
 - 1.3 Housing :SUS20/1304 surface nickel-plated
2. Electrical characteristics:
 - 2.1. Contact area: contact resistance 40m Ω Max, allowing 10m Ω Test conditions :20mv, 100mA measurement:
 - 2.2. Contact current :3A VBUS pin; 1.25A for GND Pin; The other pins are 0.25A.
 - 2.3. Rated voltage :5V.
 - 2.4. Withstand voltage :100VAC.
 - 2.5. Insulation resistance :3 at least 100 megohm
3. Mechanical properties:
 - 3.1. Insertion force :0.5-2.0Kg
 - 3.2. Pullout force :0.6-2.04Kg
 - 3.3. Insertion and removal times :10000 times.
4. Working environment :-20°C to +85°C
5. Resistance to welding heat: the terminal is immersed in a tin tank at 250 °C; Through the When 3-5S is 0.5Sec, the tin-stained area is more than 95%
6. Appearance: The parts can withstand the following welding conditions: temperature 250°C, time 8-10 seconds, appearance no damage deformation

TOLERANCE			东莞市恒祺电子科技有限公司 Dongguan Hengqi Electronic Technology Co., Ltd		
X. XXX	± 0.05				
X. XX	± 0.15	https://www.hq-dz.com			phone:15812872448
X. X	± 0.20	TITLE: TYPE C 6P立式直插H=5.0		PART NO:TYPE-C6P-LC1051A	
X.	± 0.30			DRAWING NO:8.85*5.0*3.06	
ANGLE	$\pm 5.0^\circ$				
PROTECTON 	DRAWN:		DATE:	18-10-08	UNIT: mm
	CHECKED:		DATE:	18-10-08	SCALE: FULL
	APPROVED:		DATE:	18-10-08	SIZE: A4