

RoHS2.0  
Compliant

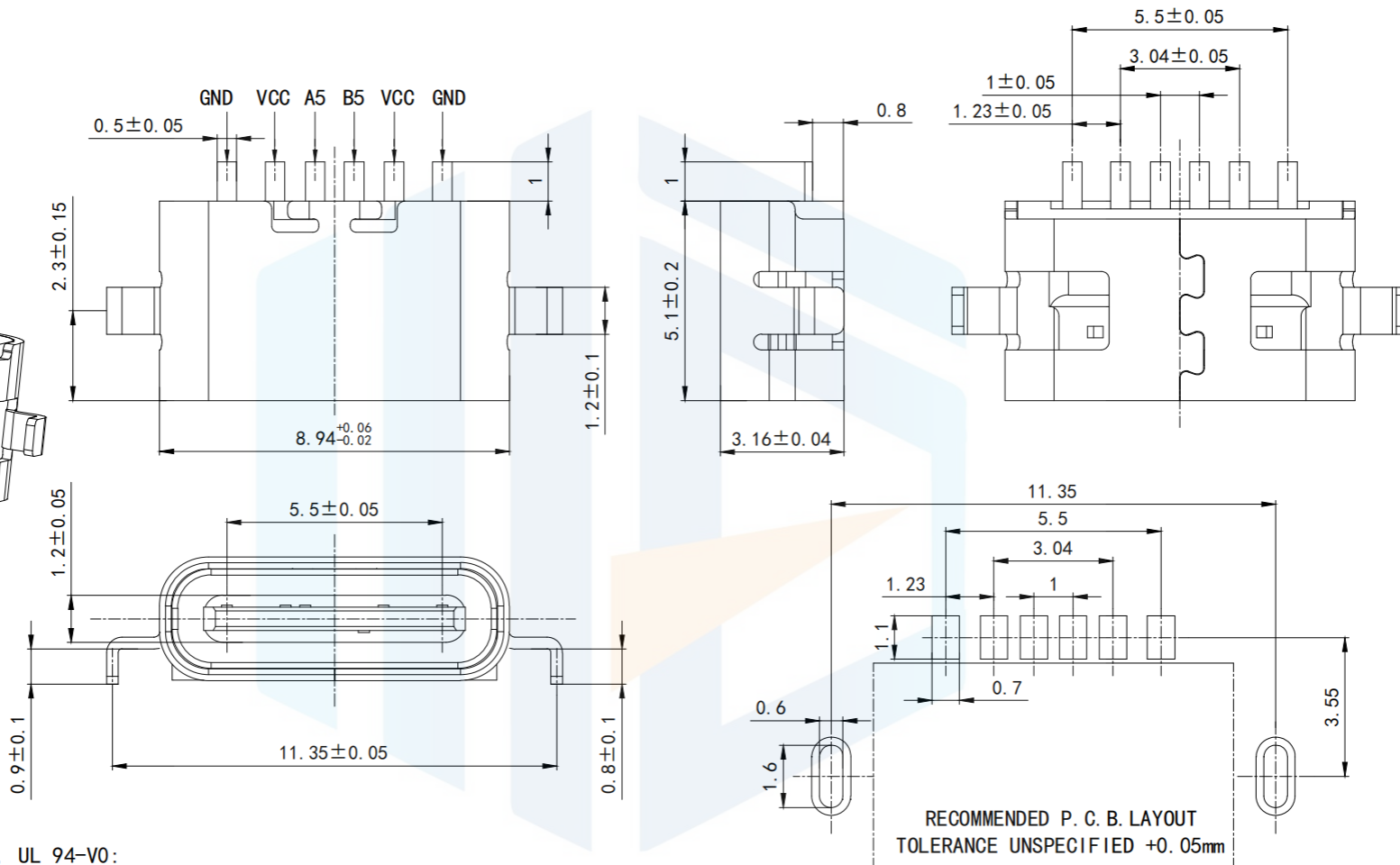
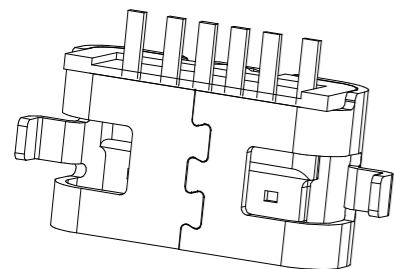

RECOMMENDED P. C. B. LAYOUT  
TOLERANCE UNSPECIFIED +0.05mm

1. Materials

- A. Body: LCP, Black, White, UL 94-V0;
- B. Terminal: H65 copper, electroplating brush gold;
- C. Shell: stainless steel, full nickel plating;

2. Main features

- A. Voltage level: 20V AC;
- B. Current: 3A;
- C. Working temperature: -40° C~85° C;

3. Electrical requirements:

- A. Contact resistance: 40m $\Omega$  Max, (initial), 50m $\Omega$  Max. (finally);
- B. Voltage: 100V AC for 1 minute;
- C. Insulation resistance: 100M min. Dc 500v;

4. Mechanical properties:

- A. Insertion force: 5~20N. (from 1~3,000 times);
- B. Pull-out force: 8~20N. (from 1~1,000 times): 6~20N. (from 1,001~3,000 times);
- C. Durability life: 3,000 times;

TOLERANCE

X. XXX	±0.05
X. XX	±0.15
X. X	±0.20
X.	±0.30
ANGLE	±5.0°

PROTECTON

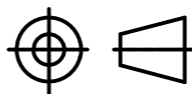

东莞市恒祺电子科技有限公司

Dongguan Hengqi Electronic Technology Co., Ltd

<https://www.hq-dz.com>

phone:15812872448

TITLE:

TYPE C 6P沉板0.8 L=5.1  
2定位脚插板

PART NO:TYPE-C6P-CB1016A

DRAWING NO:8.94\*5.1\*3.16

DRAWN:

CHECKED:

APPROVED:

DATE: 18-10-08

DATE: 18-10-08

DATE: 18-10-08

UNIT:  
mm

SCALE:  
FULL

SIZE:  
A4

